

# Conserv v40 LED Panel Light Installation Instructions

## Warning

- Inherently protected
- Vapor barrier must be suitable for 90°C
- Min 90°C supply conductors
- Suitable above ceiling required
- Suitable for dry locations
- This product to be installed in accordance with the application installation code by personnel professional for construction and electrician.

### PLEASE READ THESE INSTALLATION INSTRUCTIONS CAREFULLY BEFORE INSTALLING OR MAINTAINING THIS EQUIPMENT.

Luminaires to be used with independent control gear supplied separately:  
Mean Well: LCM-40

#### 1. Installation Selections Chart

Size (mm)	Power (Watts)	Voltage	Installation			
			Wall Mount	Recessed Mount	Suspension	Ceiling Mount
595x595	40W	50/60Hz 200-240Vac	✓	✓	✓	✓
295x1195	40W	50/60Hz 200-240Vac	✓	✓	✓	✓
620x620	53W	50/60Hz 200-240Vac	✓	✓	✓	✓
620x620	53W	50/60Hz 200-240Vac	✓	✓	✓	✓

#### 2. Storage

Prior to installation products are to be stored in cool and dry conditions.

#### 3. Application

The installation application and orientation of the product is designed in accordance with the nominated product IP rating, class designation and these installation instructions. Installation environments and operating conditions beyond these instructions are not recommended.

#### 4. Installation/ Special Conditions

**(relevant only for products approved for such an installation)**

(a) products installed in high wind environments must have suitable installation / fastening methods applied to ensure the product's mounting points are not damaged through, corrosion, constant vibration and or movement. Exterior products are designed with precise vertical aiming limits, which should not be exceeded. Any vertical floodlight aiming requirements should be specifically validated in writing with the relevant brand before consideration.

(b) products installed in corrosive or salt laden environments require special consideration and such; specific product selection, inclusive of suitable fastening methods and extensive ongoing maintenance of products installed in these environments require professional advice. It is essential that all aspects of the product selection, material specification and maintenance are specifically designed for such use and a cleaning program be adopted that maintains the design integrity of the product.

(c) interior highbay products must be vertically suspended. The method of suspension (chain etc) must be able to support at least 5 times the total weight of the fitting. Do not install where air movement will cause the fitting to swing about, causing wear and tear of attachment points. Luminaires should be installed where access for maintenance is practical and allows for maintenance to be completed in accordance with the manufacturer's recommendations.

(d) interior (panel) products must be installed to ensure the lamp unit or the driver (if supplied) are not covered with any combustible materials or insulation; minimum spacings nominated for these materials are mandatory. Unless otherwise specified, minimum clearances are in accordance with AS3000 requirements. The product is not designed for installation environments which restrict conventional airflow movements eg: enclosed boxes or concrete profiles. For dimming purposes please see the relevant product brand web site for the dimming compatibility chart. When mounting multiple fixtures to conductive structures, it is recommended that the structure is earthed. The mounting facilities provided for the transformer/driver (if any), need only be utilised if in the application of the product is required by AS3000. IP ratings stated (if any) are from below the ceiling unless stated otherwise and the installation of the product must be in a manner that maintains the integrity of the relevant IP rating.

#### 5. Safety Warnings

Type Y cord connection  
NO DIY, Non-replaceable LED source  
RISK OF OVERHEATING OR FIRE IF THE CLERANCE DISTANCES ARE COMPROMISED  
RISK OF FIRE – REQUIRED CLEARANCE FROM STRUCTURAL MEMBERS AND BUILDING ELEMENTS (For Australia and New Zealand)

- Minimum clearance distance from the top of the luminaries to any normally flammable building element is 40mm
- Minimum clearance distance from the side of the luminaries to any normally flammable building element is 25mm

#### For New Zealand

- Minimum clearance distance from the top of recessed luminaries to any normally flammable building element is 20mm
- Minimum clearance distance from the side of recessed luminaries to any normally flammable building element is 15mm

## Conserv v40 LED Panel Light Installation Instructions

### Suspension

Please insure that the wall is made of solid concrete, and the thickness must more than 50mm, or the lamp will fall down! The install diameter shouldn't more than 6mm.

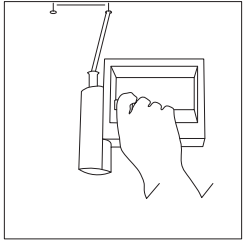

1. Please check the fitting bag with components list.
2. Please according to the specification, slotting a hole on the ceiling as the photo shows, diameter 6mm deepness 35mm.

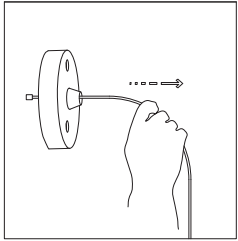

4. Please put the upper suspended rope into the hole of the flange to insure the end cap inside in the flange.

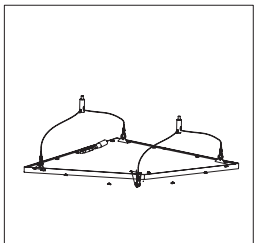

6. Please fix the under suspend rope in the lamp.

The end cap must be locked by spanner, otherwise it will fall off as time going.

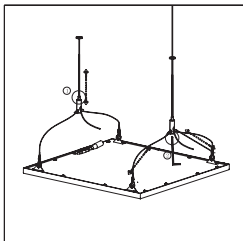

8. Adjusting the suspend rope to reach the advisable height.

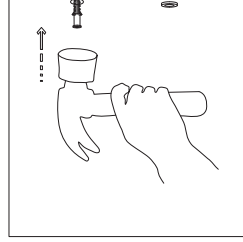

3. Please put the expanded screw into the hole, insure the external rim is abreast with the wall.

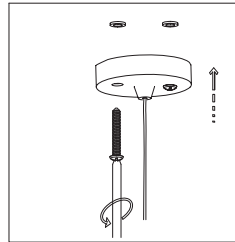

5. Please fix the flange on the ceiling by self-tapping screw.

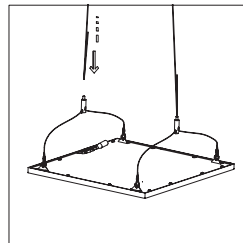

7. Please thread another side of the upper suspend rope into hasp.

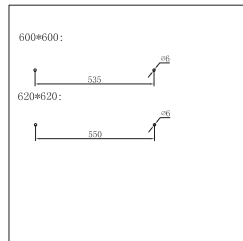

- Add 1: Tapping site view of ceiling.

### Recessed Mount

SPEC	Size/mm	External size of Tchannel/mm	N.W/Kg
6060	595 ± 1(L)*595 ± 1(W)	580 ± 1(L)*580 ± 1(L)	4.0
6262	620 ± 1(L)*620 ± 1(W)	605 ± 1(L)*605 ± 1(L)	4.2

1. Please check the fitting bag with components list.
2. Comparing with the specification as follows, judging if the ceiling is meeting the installation requirement for recessed installation.

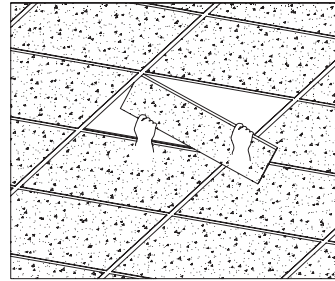

3. Take the ceiling panel down.

Please confirm the dimensions of the ceiling channel and the lamp is matching.  
Please confirm load-bearing is enough to support the lamp.

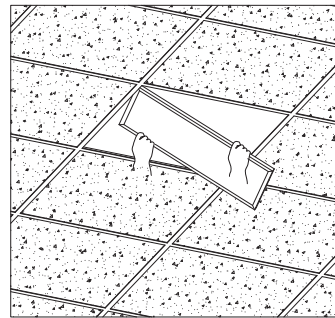

4. Please put the lamp front down, tilt 30-45 degree, put it into the ceiling channel.

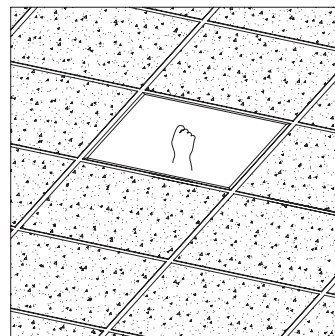

5. Please check if the lamp have been fixed in the ceiling channel.

The lamp must be fully recessed into the channel, and insure there are the space for adjusting the lamp, the space shouldn't more than 3mm, otherwise the lamp will fall down.